

ANTIVIBRATORY SHELL MILL ADAPTORS

for cutters with driving slot DIN 138



A.11/20.160



Manufactured
for Tapers as per:

DIN 69871-A
JIS 6339 - BT

- SPECIAL FOR MOULD AND DIE MAKERS.
- REDUCE VIBRATION UP TO 60% COMPARED TO ANY OTHER CONVENTIONAL SHELL MILL ADAPTOR.

Antivibratory Shell Mill Adaptors manufactured with materials and mechanisms having antivibration properties.

Sidelocks and Collet Chucks available upon request.

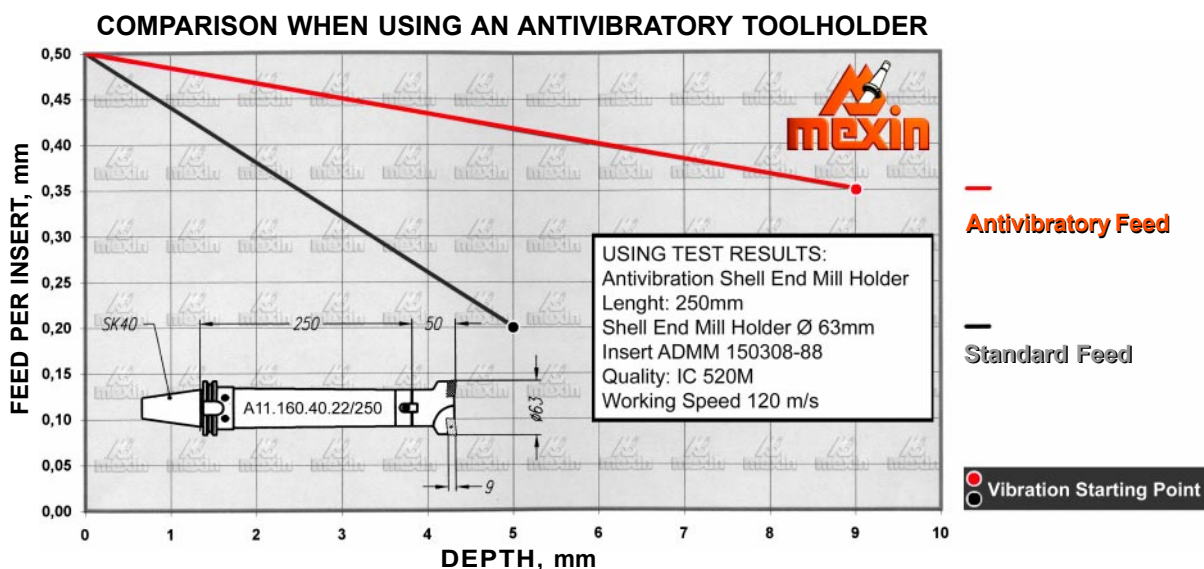

ISO 50 Toolholders as per DIN 69871 and JIS 6339-BT could become DIN 2080 Tapers by using the special Pull Stud Ref. A-85.752.50.50.

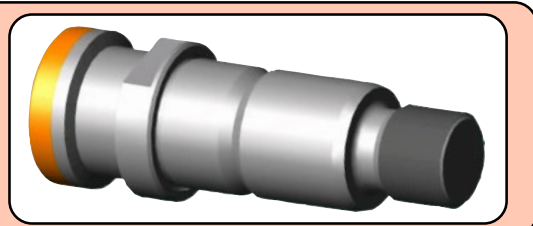

Camí de Lourdes nº1
E-08358 ARENYS DE MUNT
Barcelona
Tel: 93 793 98 51
Fax: 93 795 13 57
www.mexin.es mexin@mexin.es

EXCLUSIVE DISTRIBUTOR:



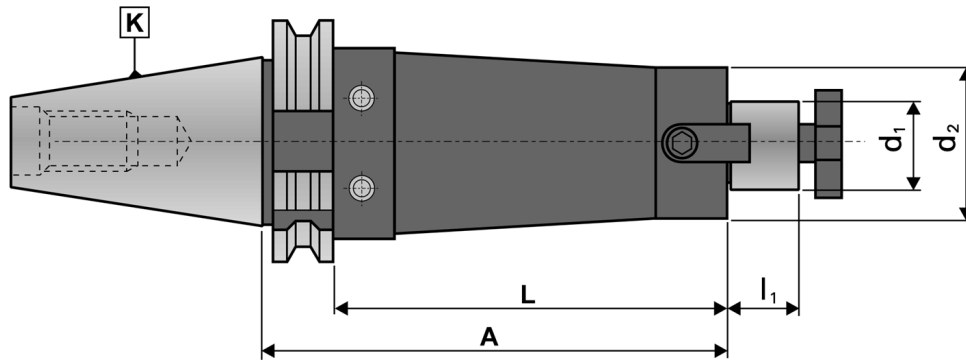

ANTIVIBRATORY
SHELL MILL
ADAPTORS

A.11/20.160

DIN 69871-A	K ISO	d ₁ h ₆ mm	A mm	I ₁ mm	d ₂ mm	L mm
A.11.160.40.22/150	40	22	150	19	44	131
A.11.160.40.22/200		22	200	19	44	181
A.11.160.40.22/250		22	250	19	44	231
A.11.160.40.22/300		22	300	19	44	281
A.11.160.40.27/150		27	150	21	54	131
A.11.160.40.27/200		27	200	21	54	181
A.11.160.40.27/250		27	250	21	54	231
A.11.160.40.27/300		27	300	21	54	281
A.11.160.50.22/200	50	22	200	19	44	181
A.11.160.50.22/250		22	250	19	44	231
A.11.160.50.22/300		22	300	19	44	281
A.11.160.50.22/400		22	400	19	44	381
A.11.160.50.22/500		22	500	19	44	481
A.11.160.50.27/200		27	200	21	54	181
A.11.160.50.27/250		27	250	21	54	231
A.11.160.50.27/300		27	300	21	54	281
A.11.160.50.27/400		27	400	21	54	381
A.11.160.50.27/500		27	500	21	54	481
A.11.160.50.32/200		32	200	24	54	181
A.11.160.50.32/250		32	250	24	64	231
A.11.160.50.32/300		32	300	24	64	281
A.11.160.50.32/400		32	400	24	64	381
A.11.160.50.32/500		32	500	24	64	481

JIS 6339 - BT	K ISO	d ₁ h ₆ mm	A mm	I ₁ mm	d ₂ mm	L mm
A.20.160.40.22/150	40	22	150	19	44	116
A.20.160.40.22/200		22	200	19	44	166
A.20.160.40.22/250		22	250	19	44	216
A.20.160.40.22/300		22	300	19	44	266
A.20.160.40.27/150		27	150	21	54	116
A.20.160.40.27/200		27	200	21	54	166
A.20.160.40.27/250		27	250	21	54	216
A.20.160.40.27/300		27	300	21	54	266
A.20.160.50.22/200	50	22	200	19	44	162
A.20.160.50.22/250		22	250	19	44	212
A.20.160.50.22/300		22	300	19	44	262
A.20.160.50.22/400		22	400	19	44	362
A.20.160.50.22/500		22	500	19	44	462
A.20.160.50.27/200		27	200	21	54	162
A.20.160.50.27/250		27	250	21	54	212
A.20.160.50.27/300		27	300	21	54	262
A.20.160.50.27/400		27	400	21	54	362
A.20.160.50.27/500		27	500	21	54	462
A.20.160.50.32/200		32	200	24	54	162
A.20.160.50.32/250		32	250	24	64	212
A.20.160.50.32/300		32	300	24	64	262
A.20.160.50.32/400		32	400	24	64	362
A.20.160.50.32/500		32	500	24	64	462